



MondialpolServiceGroup

Mobile Cash Center

Cascais, May 2017

Nicola Nugnes
COO - Vedetta 2 Mondialpol

Francesco Solare
Security Manager - Mondialpol Facility



Cash management



Mobile Security Patrol



Armed/Unarmed Guards



❑ C.I.T. and Cash handling

13 Counting Centers

More than 250 armoured vehicles

Main Customers: Bank and Retail Companies

❑ Patrols

Alarm/Video Surveillance, response patrols, inspections. All these activities are coordinate by modular and integrable Control Rooms

Main Customers: Private Companies, Public authorities e Private customers

❑ Armed Guards/Unarmed Guards/Reception

Main Customers: Bank and Private Companies

❑ Technical Support/Management/Purchasing/Maintenance for Alarm Systems

Elmar/Company Tec Department



MondialpolServiceGroup consists of many specialized skills, divided into companies, leaders in their field.
Perfect Teamwork means perfect customization.

Operative Companies

- ❑ Vedetta 2 Mondialpol
Como, Brescia, Torino, Novara, Belluno, Padova, Jesi, Sassari, Cagliari, Arzachena
- ❑ Mondialpol Milano
- ❑ Mondialpol Bergamo
- ❑ Mondialpol BTV (Udine)
- ❑ Vigilanza Umbra Mondialpol (Perugia)

Specialized Companies

- ❑ Mondialpol Network
Technical Support and Management of: Armed Guards, Unarmed Guards, Security Systems
- ❑ Mondialpol Facility
Security Consulting, Risk Assessment and Risk Management
- ❑ Elmar
Technical Support/Management/Purchasing/Maintenance for Alarm Systems
- ❑ Tecnoratio
Technical Support for Physical Security



MondialpolServiceGroup_Cash Management 2016: total facts&figures

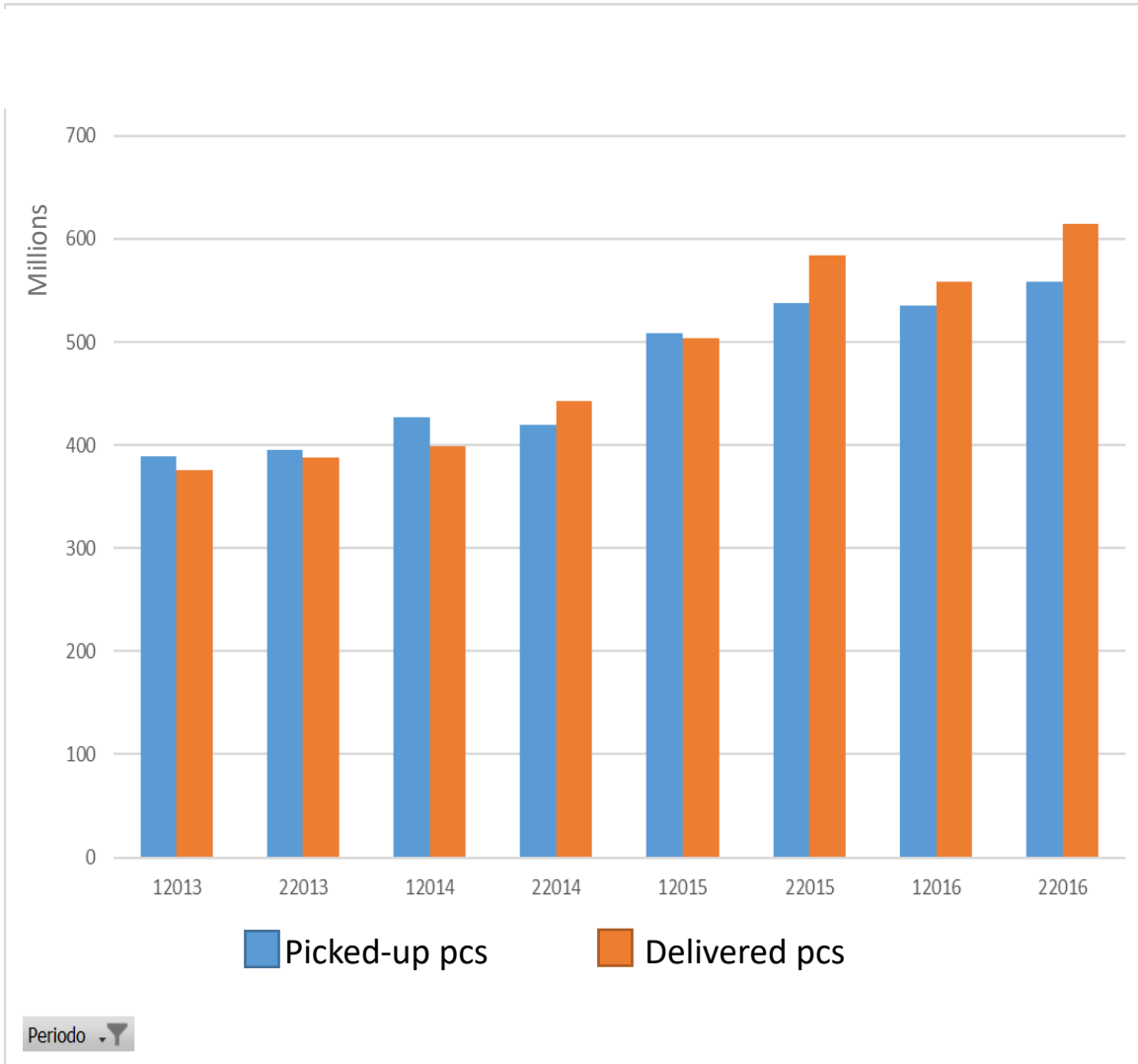

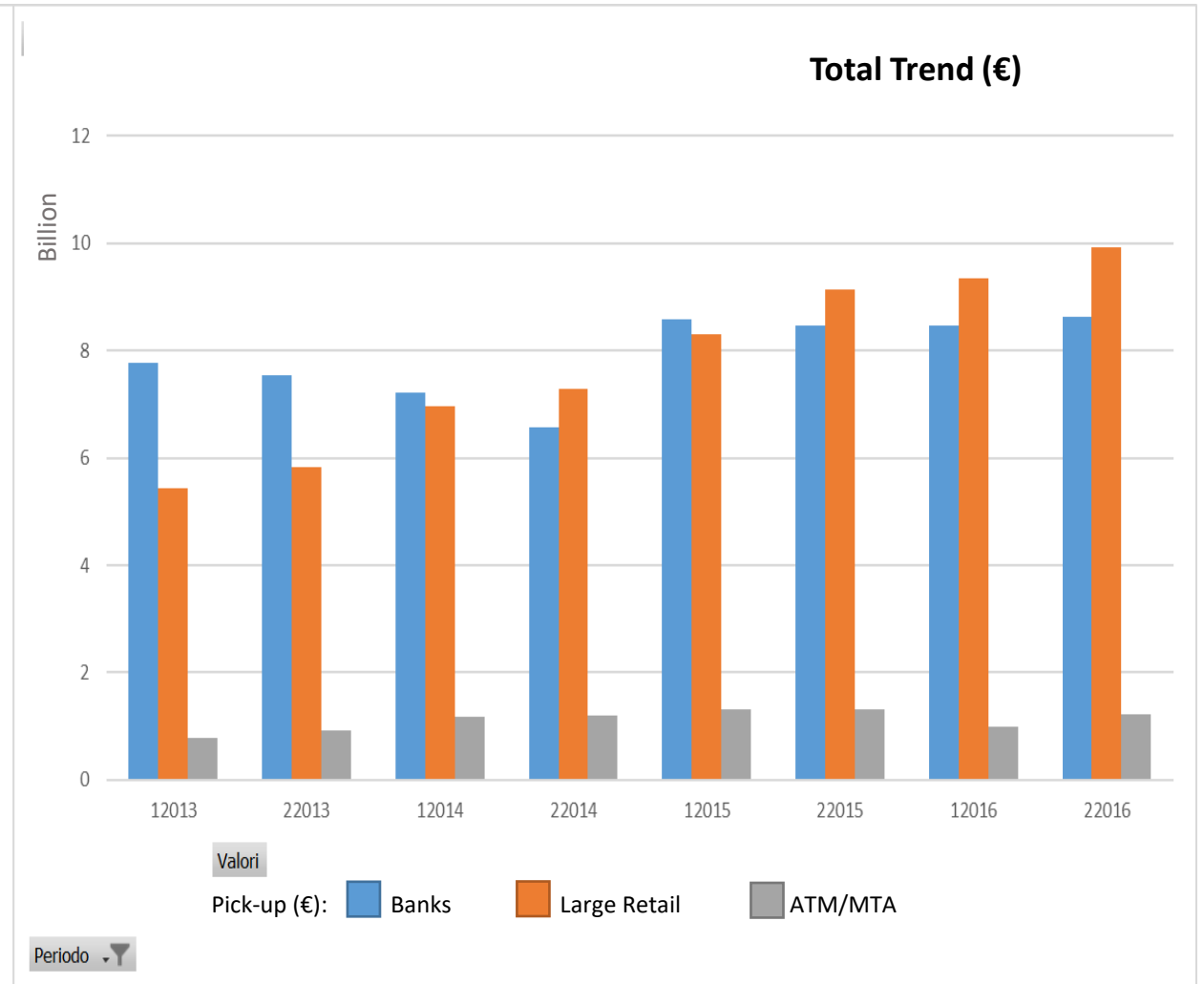
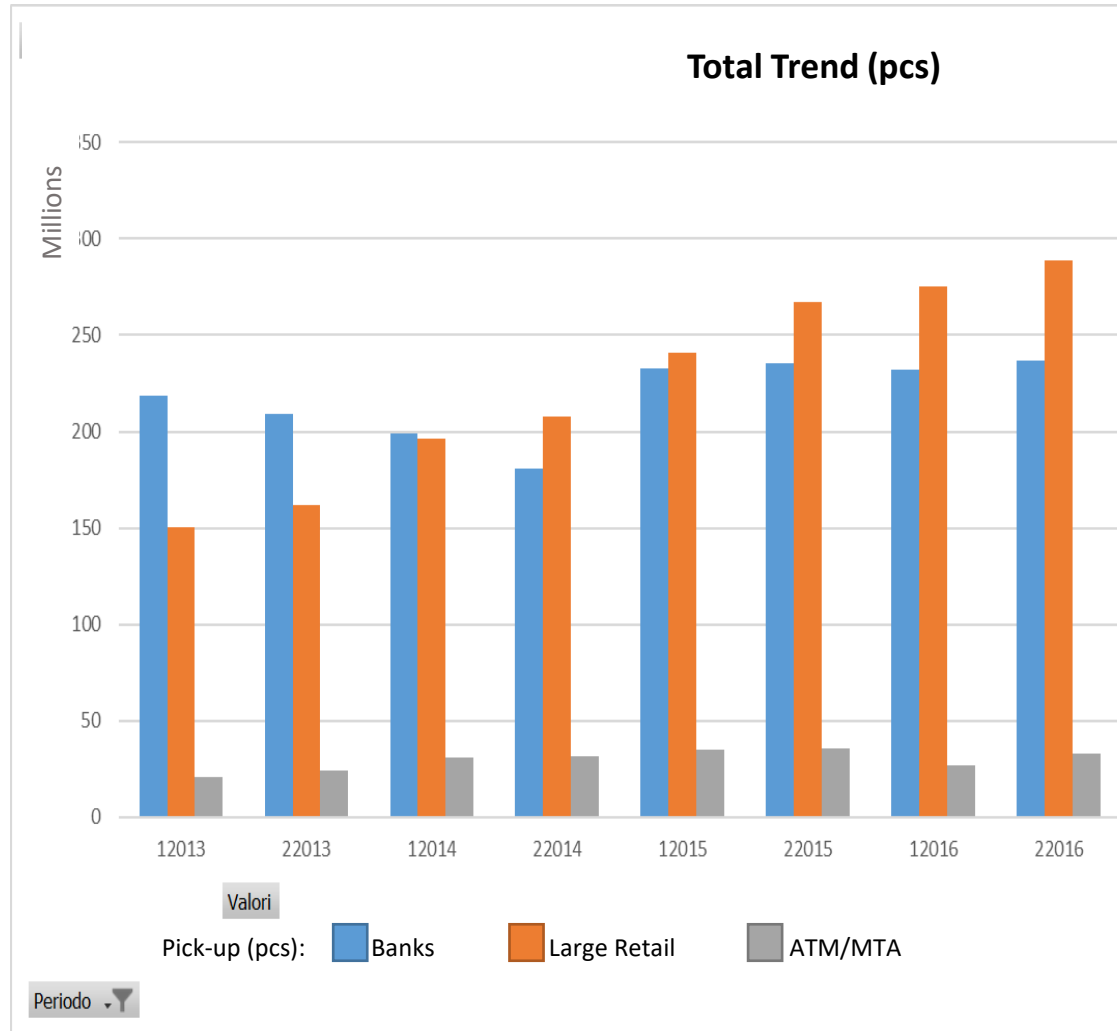



MondialpolServiceGroup_Cash Management: Deliveries

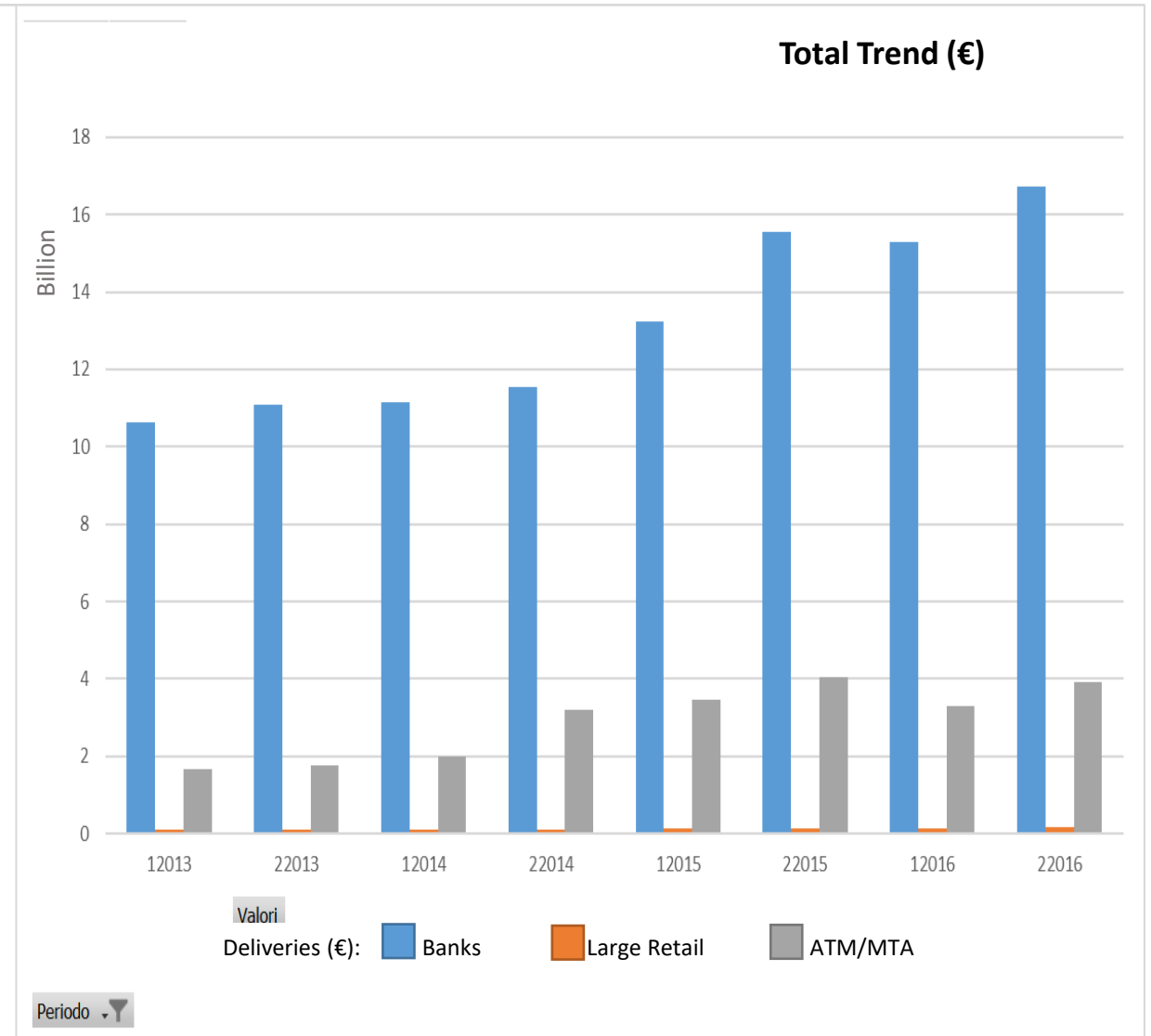
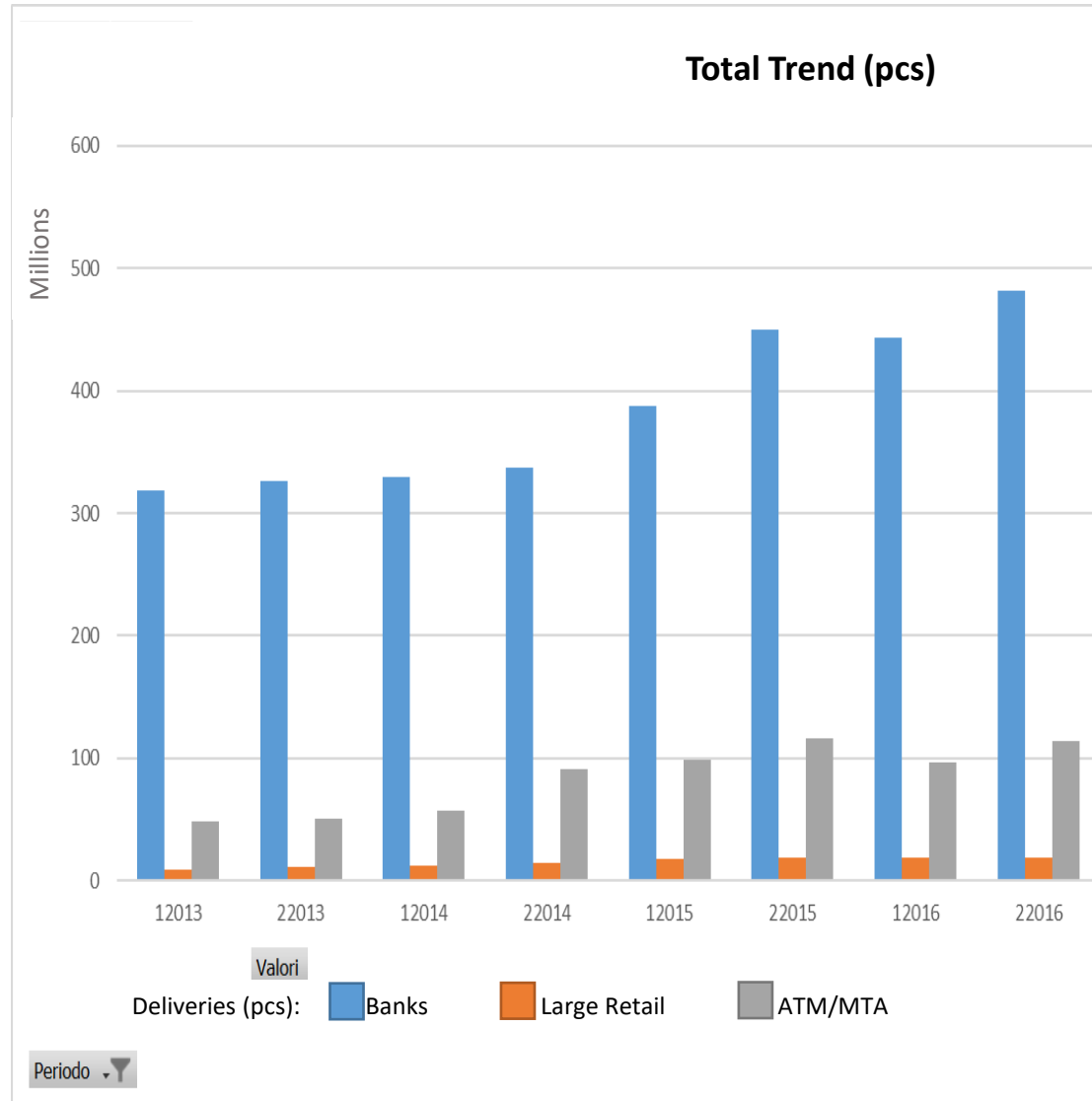

Starting from 2013 the Bank of Italy has set up a working group (Banks, CIT and GDO), whose aim was that of studying an operative approach for the Cash Business Continuity.

The outcome of this working group has been the institution of a National Committee, coordinated by the Bank of Italy, with the purpose to create a procedure in order to face critical situations able to stop the normal cash recycling.

Every CIT involved has provided their own information about their operative structure (men and armoured vehicles), and their availability in case of crisis. Nonetheless, the main problem still remains how to manage the «Cash Center» eventually involved in the emergency.

Here below, you find the two solutions suggested by the Working Group:

1. Identify buildings and back-up structures, where to move personnel and equipment, in order to restore the normal operations. This activity allowed to provide to the Committee a list with all these sites (and Their location) as well as the procedures Necessary to activate them.
2. Realize an integrable and modular «Mobile Cash Center» able to reach areas not covered by the first solution, but even in case those buildings are no more available or suitable.

The second solution has been studied mainly because of the peculiarity of the Italian territory and its hard logistic.

As known, Italy has suffered of important “crisis” like:

- Earthquakes
- Floods
- Riots (e.g.: G8 of Genoa in 2001)
- Economic collapses of CIT Companies (especially in 2013)

The examples listed above, belong in those scenarios where could be conceivable the activation of one these solutions.

Mondialpol Service Group has chosen, voluntary, to study and realize the second one. The main reason it's because, among other things, the Group owns 14 Cash Centers and, the possibility that one of the scenarios above, could occur, it's very high, especially in some areas (e.g.: last years' earthquake in Umbria and Marche).

The study and analysis of the solution, has led us to choose what we think is better choice because it is integrable and modular: Armored Standard Container.

Standard Containers are easy to manage and place all over the world and can be easily used in many activities in cooperation with Army (not only the Italian one) and displaced on standard logistic platforms.

The basic configuration is made of:

- 3 Containers (A – (Entrance + transfer Safe + Cash collection bags opening + output valuable preparation) B (Counting + Authentication) C (armoured cabinets and toilet))
- Logistic Truck
- Security Team Container (optional)
- One ore more ATM installed on dedicated armoured Truck (pics on page 22)
- One ore more «Bank on the Road» on dedicated armoured Truck equipped with «smart cash safes» (pic on page 20)



The Project

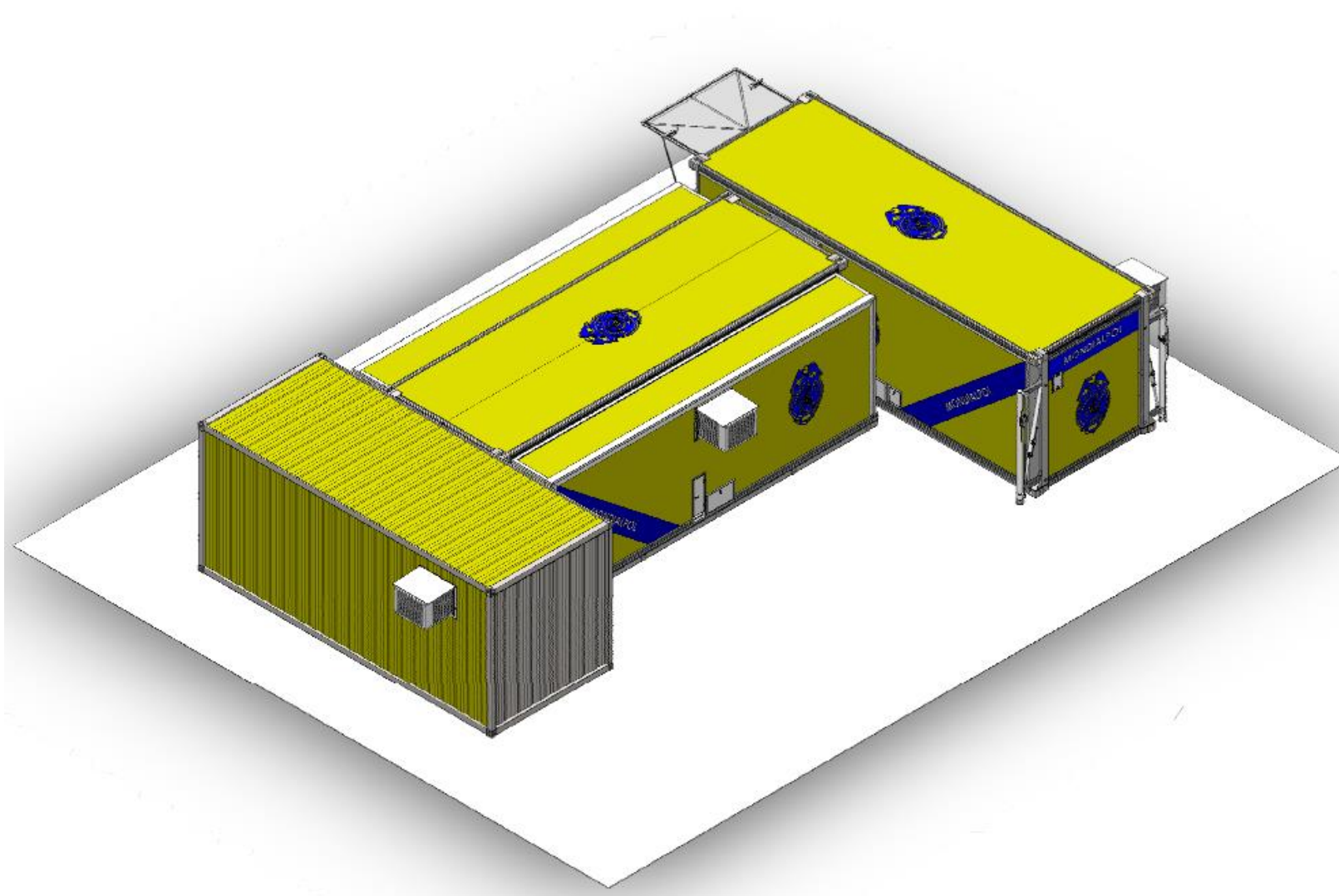

The Equipment

The "Mobile Cash Center" is equipped with:

- Armoured Area equipped with «Transfer Safe»
- 1 workstation for Cash collection bags-opening equipped with: dedicated Infrared TLC + 1 laptop + barcode reader
- 1 workstation for output-valuable preparation equipped with: dedicated TLC
- 8 workstations for Counting and Authentication equipped with: dedicated tlc + Glory GFR220 + laptops +checks scanners + barcode reader
- 1 optional workstation for selection equipped with: banknotes sorter (Glory UW600 or UW500)
- 5 armoured cabinets

This configuration allows us to have – respecting the security standards – ordinary cash counting operation during the whole emergency

The "Mobile Cash Center" is also equipped with support systems and device like:

- TVCC
- Access Control
- 1 Server
- LAN and WIFI
- UPS
- Air Conditioning
- Security Systems
- WC

Descrizione Struttura Operativa

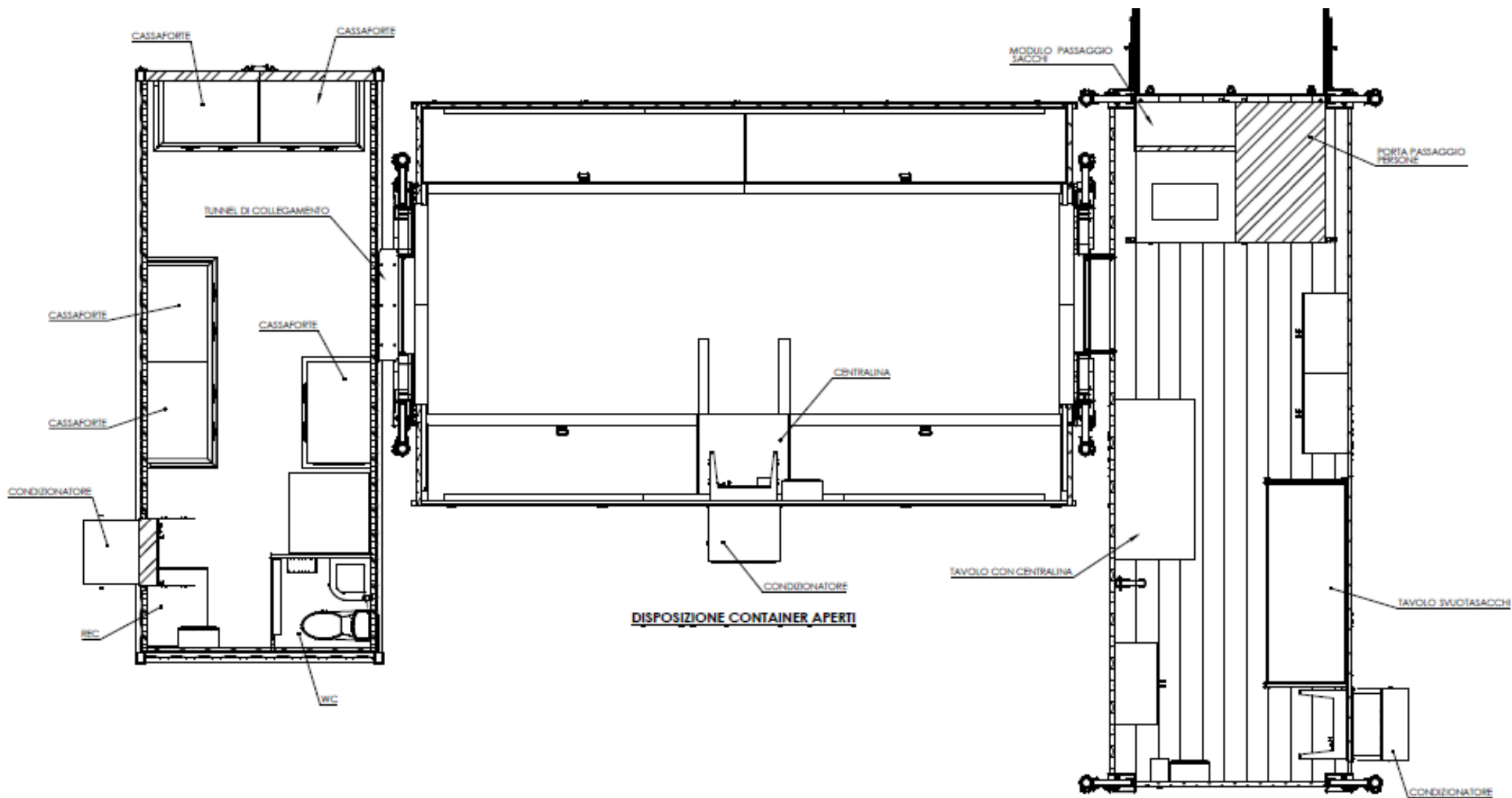



Overview





Overview





Overview





The activation and the operational continuity of the MCC, which can take place within 48h, is sustained by some support functions such as:

- **Crisis Committee** (Working Group made by the Company's key figures with defined tasks and roles)
- **Recognition Team** (Dedicated Team, properly instructed, whose aim is that of reach the area - previously defined – in order to value its availability and its viability)
- **Security Squad** (Dedicated Team, properly instructed, whose aim is that of create and protect a 24h safe area around the MCC). The team, with work and rest shifts, is positioned in a dedicated armoured Container too.
- **Logistic Team**(Dedicated Team, properly instructed, whose aim is the logistic support to the personnel)



It should be noted that the MCC has been not studied only for MondialpolServiceGroup. This solution, actually, can be both provided to other CIT Companies, both integrated with other solutions studied by those Companies willing to replicate totally or partially the MCC.

Obviously, Companies that do not belong to MondialpolServiceGroup, wishing to take advantage of this solution, will need to subscribe appropriate contractual agreements.



- Can we all have the same logistical standards?
- Could be useful to agree a standard data exchange?
- In Europe, how many other SCM may we need?
- Do you think could be appropriate to sign an ESTA "Memorandum of understanding"?

Actions

- Provide and assume an European Standard data exchange protocol
- Define how to support the design and planning of new SCM
- Set up a working group in ESTA to manage the coordination of activities

On this section we will show you 2 more solutions (mentioned before), studied by MondialpolServiceGroup, devoted to public, like customers and the GDO

The projects are:

1. Bank on the Road
2. ATM on Armoured Truck

An Armoured Vehicle normally used for the CIT, has been properly modified in order to install 2 «smart cash safe» in it and connected via GSM to the our Cash Centers.

This Truck, with 2 armed Guards (one of these belonging to a Cash Center), will reach the retail in order to pick up the values. The safe-bag delivered by the customer, must contain the bill too (no coins or check)

Once on the truck, the Guard will insert the badge with the customer ID, will insert the values into the safe and, at the end of the operation, if requested, he will deliver to the customer, the report with the details of the operation.

This transaction will be automatically send via GSM to the Cash Center software.

In case of differences between what declared and what counted, could be used the images recorded by the «body cam» which the guard is equipped, used during the operation of safe-bag opening and values insertion.

Two «smart cash safe» will be installed, both with 2 drawers (2400 pcs each) in order to reserve each drawer only one bank. In this way the truck will be equipped with 8 drawers for a maximum amount of € 500.000



Internal:
Values Room





ATM on Armoured Truck_The Project

This project has been studied in order to guarantee the ATM service even in peculiar situations where the Customer Bank needed to activate this extemporaneous solution.

Having verified the effectiveness of this solution, it was supposed to replicate it in those areas that, for reasons such as earthquakes, floods, etc., need an ATM service

The solution shown in the next slide, developed in cooperation with «Banca Popolare di Spoleto», has been successfully tested and fully functional.

It's an ATM machine, installed and managed from the inside of the armoured truck, constantly manned, available to the public, wherever necessary. In case of emergency, this vehicle might precede the arrival of the MCC.



Furgone ATM_Overview



Together with the MCC project, MondialpolServiceGroup has developed other solutions aimed at improving its Security assets – basic to reduce the risk and at the same time, increase the activities in support of Business Continuity Plan.

Actions taken, can be divided in two type:

- Passive security improvement
- Active security improvement

Concerning passive security, a lot of reinforcement actions have been implemented:

- ☐ facilities (reinforced walls, new security systems on the access gates, watch towers for tactical surveillance, new systems for alarm and diffusion for emergency communications))
- ☐ Armoured Trucks (special vehicles like Bulldog, «Tasso del miele») alarm sensors and armouring strengthening

Active security: each site has prepared an Emergency Plan Attack. At the moment the training activities are in progress.



... con più di **1.500** professionisti ci
prendiamo cura della tua **sicurezza**.



Any Questions?



MondialpolServiceGroup



MondialpolServiceGroup

www.mondialpol.com

Nicola Nugnes

Vedetta 2 Mondialpol S.p.A. – Como
C.O.O.

nicola.nugnes@mondialpol.it

tel. +39 031 3389680 - fax +39 031 3389312

mob. +39 342 8031588

Francesco Solare

Mondialpol Facility s.r.l. – Brescia
Security Manager

francesco.solare@mondialpolfacility.it

tel. +39 030 8080025- fax +39 030 8080088

mob. +39 335 6706539